

Product Information

Control No. : ARL-466001-F 1

Issued on March 25, 2014

Application : Balance Filter for Bluetooth & Wireless LAN

1. Type No.

DBF81F001 - T

RoHS Compliant Parts

2. Dimension (Unit : mm)

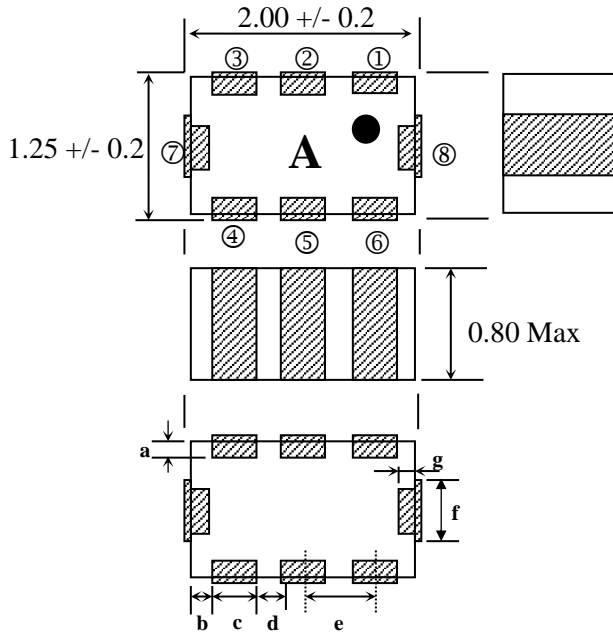

Terminal	
①	Unbalance
②	DC
③	NC
④	Balance
⑤	GND
⑥	Balance
⑦	GND
⑧	GND

Terminal Dimensions	
a	0.15 Typ.
b	0.20 +/- 0.15
c	0.30 +/- 0.10
d	0.35 +/- 0.10
e	0.65 +/- 0.10
f	0.50 +/- 0.10
g	0.15 Typ.

3. Electrical characteristics

Pass band	Specification	Typical	Unit	Remark
fc (Center frequency)	2450	-	MHz	
Pass band frequency	2400-2500	-	MHz	
Unbalance Port Impedance at fc	50	-	ohm	Nominal
Balance Port Impedance at fc	100	-	ohm	Nominal
Insertion Loss at 25degC.	2.5 Max.	2.06	dB	
Insertion Loss at -40 to +85degC.	2.7 Max.	-	dB	
Unbalance port VSWR in BW	2.0 Max.	1.43	-	
Balance port VSWR in BW	2.0 Max.	1.47	-	
Ripple	1.0 Max.	0.30	dB	
Amplitude balance	1.0 Max.	0.17	dB	
Phase differential	180±5	178.3	deg	

Attenuation	Specification	Typical	Unit	Remark
880 MHz - 960 MHz	35 Min.	53.20	dB	
1710 MHz - 1910 MHz	25 Min.	31.70	dB	
4800 MHz - 5000 MHz	25 Min.	34.87	dB	2*f
7200 MHz - 7500 MHz	25 Min.	39.92	dB	3*f

4. Note

- | | |
|--|---------------------------------|
| 4.1 Operating Temperature Range | : -40 to +85 deg.C |
| 4.2 Storage Temperature Range before soldering in taping package | : -20 to +35 deg.C |
| 4.3 Minimum Ordering Quantity | : 2,000 pcs (per reel, per bag) |

Approved by	Confirmed by	Raised by
T.Hirai	Y.Mizutani	M.Urano

SOSHIN ELECTRIC CO., LTD

Product Information

Control No. : ARL-466001-F 2

Issued on March 25, 2014

5. Representative characteristics

Pass Band Frequency Response

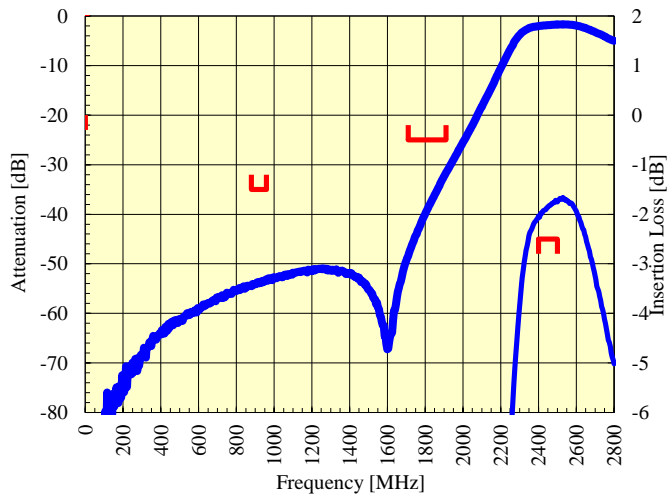

Broad Band Frequency Response

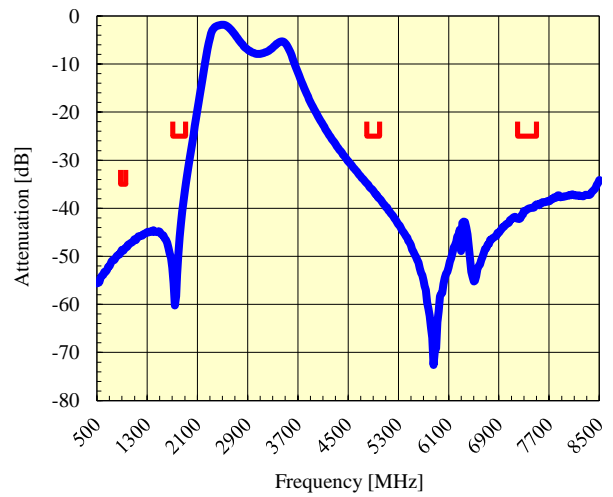

Unbalance Port Return Loss

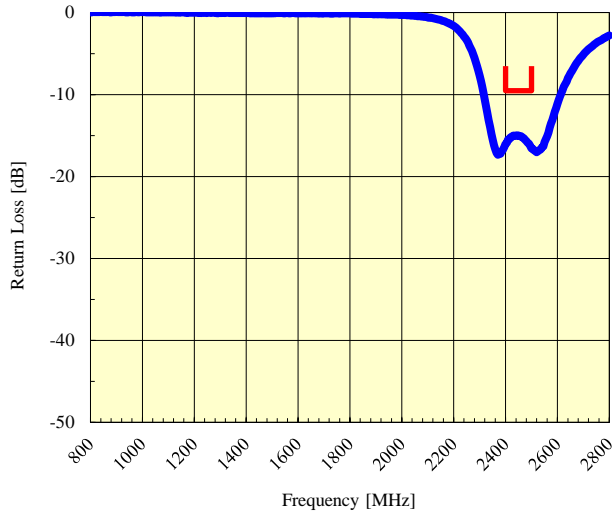

Balance Port Return Loss

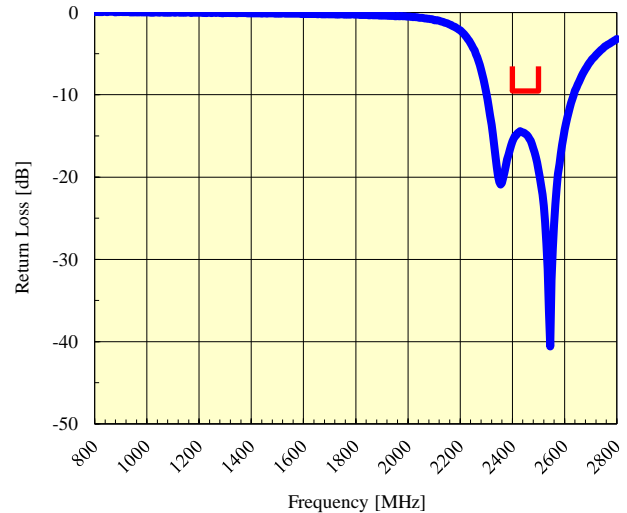

Amplitude Balance

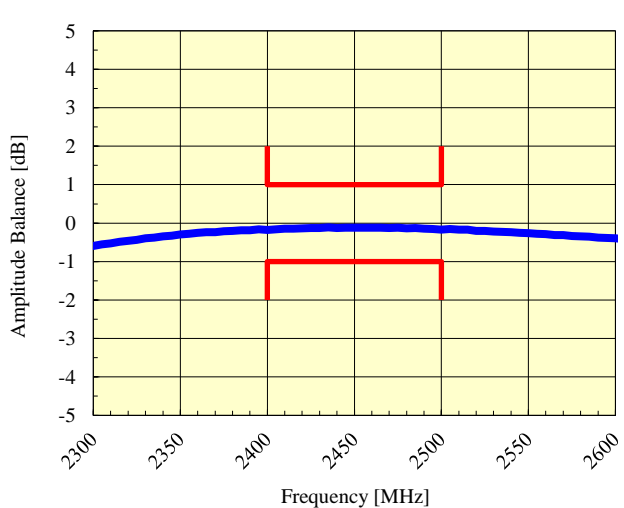

Phase Differential

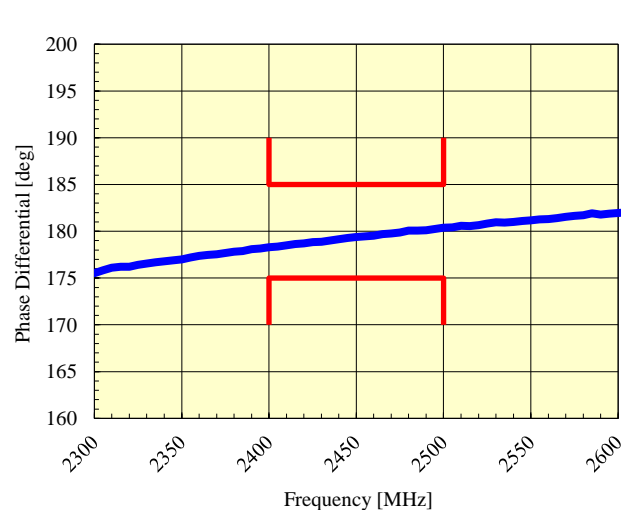

6.Recommendation Land Pattern (Unit:mm)

Land Pattern

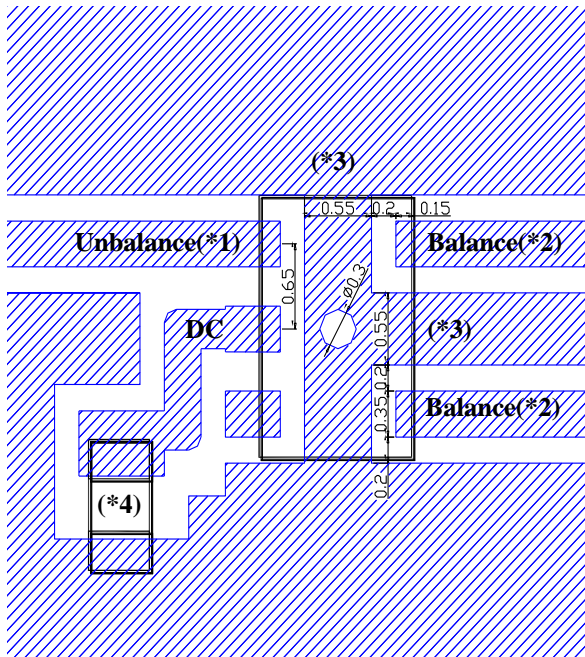

Resist Pattern

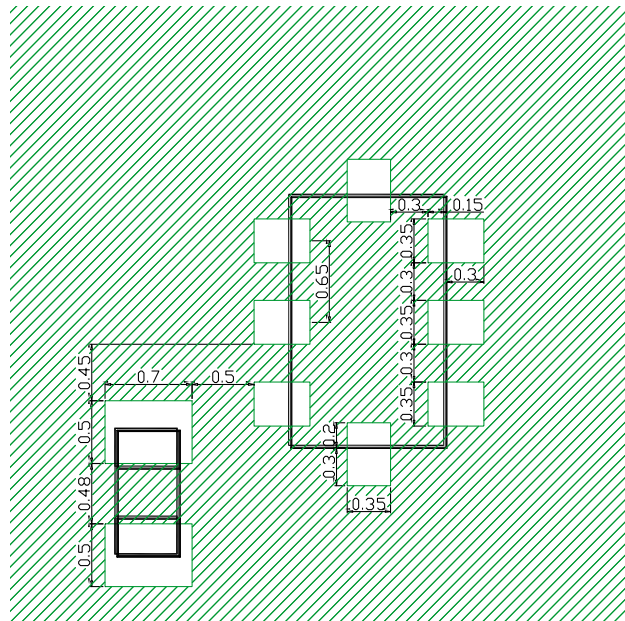

- *1 50 ohm impedance Line
- *2 50 ohm impedance Line
- *3 Ground Plane
- *4 Decoupling Capacitor = 100pF